

BOSS®

Juice
Maxx
JUICE EXTRACTOR

B-607

400
WATT

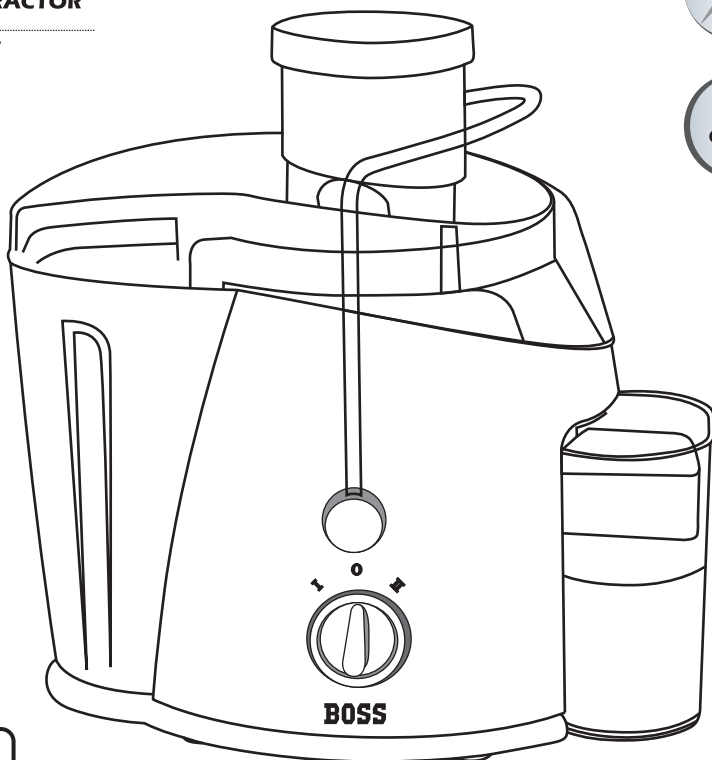

2 YEARS
WARRANTY
ON MOTOR

6 MONTHS
EXTENDED
WARRANTY
ON REGISTRATION



INSTRUCTION MANUAL

Please read all instructions carefully before using*

Dear Customer,

Thank you for choosing BOSS JuiceMaxx Juice Extractor, of which you are now the proud owner.

Drink fresh juices every day with the BOSS JuiceMaxx Juice Extractor and to stay on top of your health. Known for its Power-Packed Performance and easy usage, this appliance is driven by a sturdy motor that gives a splendid performance with low energy consumption. The BOSS Juice Extractor also features a pulp collector, which allows you to keep the pulp separate. Treat yourself with the delight of a healthy homemade juice every day.

Please read and follow all the instructions given in this user manual carefully, prior to using your BOSS JuiceMaxx Juice Extractor, to get the best result and trouble free operation.

With Best Wishes,

BOSS APPLIANCES LLP

KNOW YOUR APPLIANCE

1. Pusher
2. Protective Cover
3. S. S. Grating Filter
4. Juice Spout
5. Handle
6. Pulp Collector
7. Main Machine
8. Juice Collector

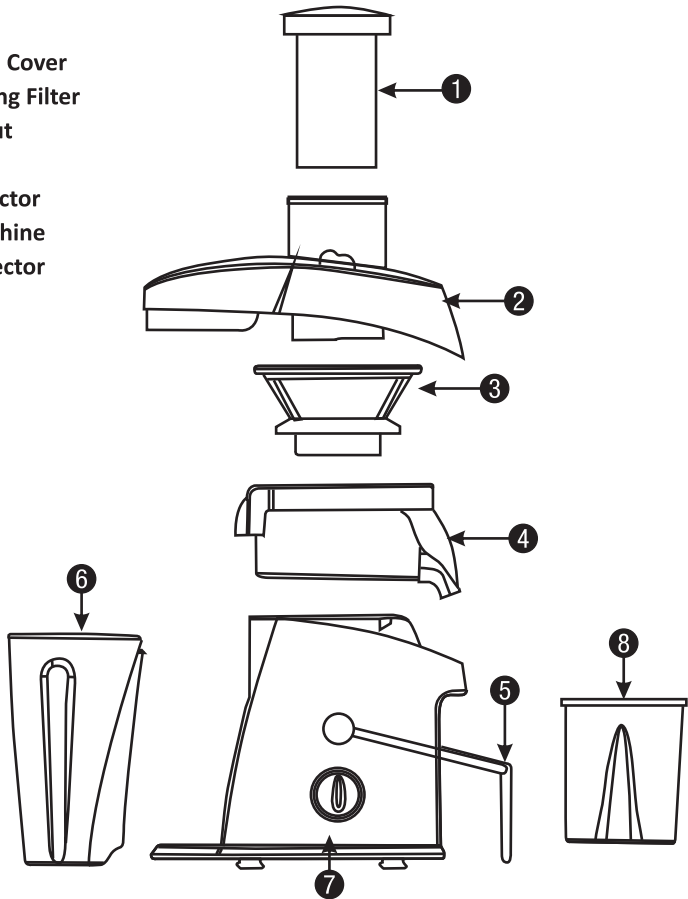

TECHNICAL SPECIFICATIONS

Model No	B-607
Power Consumption	400W 230V AC 50 Hz
Rated Continuous Working Time	1 minute
Insulation	Class F

The specifications and design are subject to change without notice*

IMPORTANT

- This appliance is not intended for use by persons (including children) with reduced physical, sensory or mental capabilities, or lack of experience and knowledge, unless they have been given supervision or instruction concerning use of the appliance by a person responsible for their safety.
- Before using, put this machine on a stable and even table board, operate according to the methods described in this user manual.
- Before juicing, ensure that the S. S. grating filter and coupler are clutched in position, and there is no hard contact between S. S. grating filter cutter and Protective cover. Put the protective cover on, fasten tight the handle, and then turn on the machine.
- Before being used, the motor works in running-in phase, there may be slight peculiar smell and spark, this is normal, after the motor works for some period, the above phenomenon will disappear.
- During juicing, make sure there is not too full juice and residue in the middle seat and residue cup, if too full, please cut off power supply, clean up, then use again.
- While operating, do not open the protective cover. In case power supply is on, do not put hand or any ware into the mixing cup or feed port to avoid any hazards or damage to the machine.
- In order to prolong service life of this machine, over-temperature protective device is mounted in the motor. If the motor works for a long time or overloaded, when over warning temperature, power supply will automatically cut off. After the motor stops, pull out plug of power supply, wait for the motor to cool (about for 30 min), use again.
- Do not pour the food out until the plug is pulled out of the power supply.
- In order to avoid any danger, when cleaning a cutter, please put the cutter under water tap for washing, do not wash it with hand.
- If the power supply cord is damaged, you must have it replaced by manufacturer, or the service centre authorized by the dealer in order to avoid a hazard.

PREPARE TO USE

- This machine is set with safety unit, when the handle does not fasten the protective cover or the S. S. grating filter is not fastened, the motor cannot turn on, so as to ensure safety for the user.
- When disassembling or assembling the juicer, press the upper of feed port of the cover with your hand, and then force the handle to slide in or out of cover slot.
- When disassembling S. S. grating filter, first remove the protective cover and residue pulp collector, then turn the middle ring up to 30 degrees by holding juice spout with your hand, and take up, the S. S. grating filter will automatically leave the rotor.
- In order to avoid damage, before using, first check power supply for compliance with rated voltage.
- Clean all parts able to disassemble (refer to the section of "Cleaning").
- When assembling, please carefully read "Know your appliance".

HOW TO USE YOUR JUICE EXTRACTOR

- Before using, ensure that the appliance is not connected to power supply and is in stop state to avoid any hazards.
- Before juicing, ensure S. S. grating filter and coupler are clutched in position, and there is no hard contact between S. S. grating filter cutter and protective cover. Put the protective cover on, put the handle into the cover slot, and then turn on the machine.
- Turn on power supply, press switch to let the machine run no-load for 5 sec. Put prepared vegetable or fruit into feed port of the juicer, press with the pusher, evenly, hard and slowly, juice of the vegetable or fruit can be found, original, fresh, and good for health.
- Note: when pressing food with the pusher, force shall be even or indirect, pressing force shall not be more than 1 kg, no too sudden force, otherwise, and juicing effect will be reduced.

OPERATING TIME

- This machine is designed with button switches of O grading, I grading, II grading (O for stop, I for weak grading, II for strong grading).
- For juicing, select strong grading, for operating time, after operating for 1min, stop for 1min, then use again.
- After the above operation is performed for three times, stop for 15 min, do not operate until the motor is cooled, in this way, service life of this machine will be prolonged, the machine will serve you more efficiently.

CLEANING

- This machine shall be often used, so as to keep the motor dry and clean.
- If not using for a long time, please store this machine at a dry and well-ventilated place so as to prevent the motor from being damped and going moldy.
- No washing the main machine. When cleaning, only wipe with wet cloth. Other Components may be washed directly with water, such as pusher, cover, juice spout, pulp collector and juice collector.