

BOSS®

BreeZe

Portable Blender

B-128

350
WATT

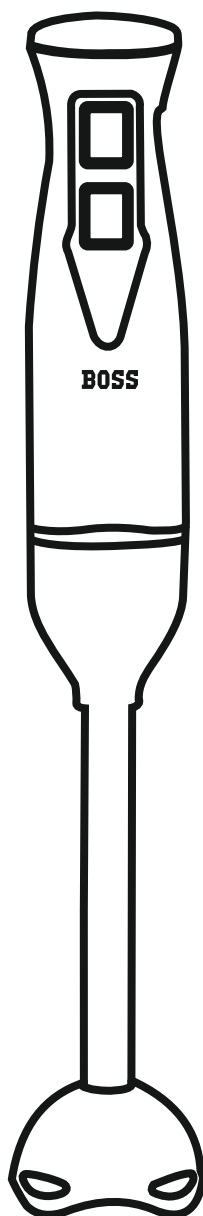

2 YEARS
WARRANTY
ON MOTOR

6 MONTHS
EXTENDED
WARRANTY
ON REGISTRATION

INSTRUCTION MANUAL

Please read all instructions carefully before using*

Dear Customer,

Thank you for choosing BOSS Hand Blender, of which you are now the proud owner.

Being the inventors of Hand Blender in India in 1985, BOSS Hand Blender enable the users to quickly blend larger quantity of ingredients. It is ergonomically designed for a better grip along with powerful motor, which consumes very less power, to offer you the best of services. Make tasty shakes or whip cream or a dip for any dish that you are planning to cook for your family with much ease.

Please read and follow all the instructions given in this user manual carefully, prior to using your BOSS Hand Blender, to get the best result and trouble free operation.

With Best Wishes,

BOSS®

KNOW YOUR APPLIANCE

- 1 Normal Speed Button
- 2 Turbo Speed Button
- 3 Motor Unit
- 4 Blending Stick

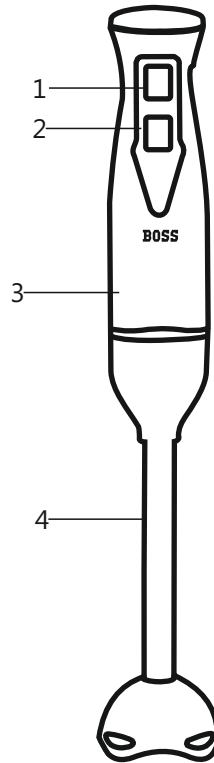

Technical Specification :

HOUSEHOLD ELECTRIC KITCHEN MACHINES- SAFETY REQUIREMENTS; HAND-HELD BLENDER, RATED INPUT POWER 100 WATTS UP TO AND INCLUDING 450 WATTS, RATED VOLTAGE 230 V, CLASS OF APPLIANCE: CLASS II, INSULATION CLASS F, DEGREE OF PROTECTION IPX0.

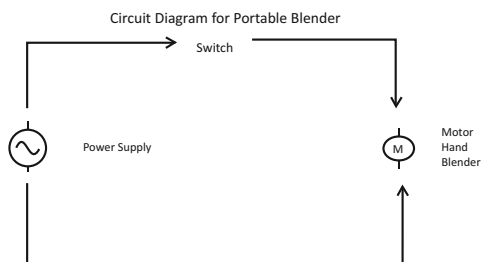

WARNING

- Check if the voltage indicated on the appliance corresponds to the local mains voltage before you connect the appliance.
- Do not use the appliance if the mains cord, the plug or other parts are damaged.
- If the mains cord is damaged, you must have it replaced by manufacturer, or the service centre authorized by the dealer, or similarly qualified person in order to avoid a hazard.
- Always unplug the appliance from the mains before you assemble, disassemble, clean or make adjustments to any of the accessories.
- Never immerse the motor unit in water or any other liquid, nor rinse it under the tap. Only use a moist cloth to clean the motor unit.
- Never let the appliance run unattended.
- This appliance is intended for household use only.
- This appliance is not intended for use by persons (including children) with reduced physical, sensory or mental capabilities, or lack of experience and knowledge, unless they have been given supervision or instruction concerning use of the appliance by a person responsible for their safety.
- Children should be supervised to ensure that they do not play with the appliance.
- Never touch the blades when the appliance is plugged in. The blades are very sharp.
- If the blades get stuck, unplug the appliance before you remove the ingredients that block the blades.
- Do not overload the appliance by putting in too much food and do not operate continuously for more than 30 seconds.

PREPARE FOR USE

- Thoroughly clean the parts that come into contact with food before you use the appliance for the first time.
- Let hot ingredients cool down before you process them (max. temperature 60°C).
- Cut large ingredients into pieces of approximately 2 cm before you process them.
- Always place the motor unit on a level surface.

USING THE APPLIANCE

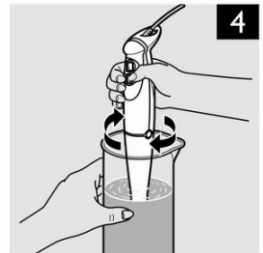
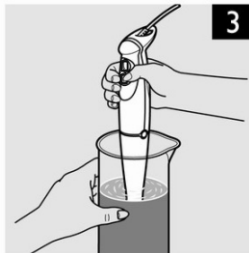
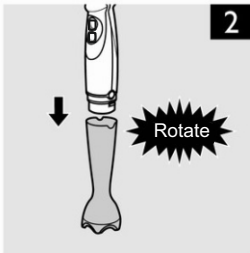

The hand blender is intended for :

- blending liquids, e.g. dairy products, sauces, fruit juices, soups, mixed drinks and shakes.
 - mixing soft ingredients
 - pureeing cooked ingredients, e.g. for making baby food.
1. Attach the blender bar to the motor unit (Fig.2).
 2. Put the ingredients in the beaker.
 3. Immerse the blade guard completely in the ingredients (Fig.3).
 4. Pressing the normal or turbo speed button to switch on the appliance (Fig.4).
 5. Move the appliance slowly up and down and in circles to blend the ingredient.

BLENDING QUANTITIES AND PREPARATION TIMES

Ingredients	Blending quantity	Time
Fruits / Vegetables	50-100g	25 seconds
Baby food, soups & sauces	50-200ml	25 seconds
Batters	50-250ml	25 seconds
Shakes & mixed drinks	50-500ml	25 seconds

CARE AND CLEANING

Do not immerse the motor unit and the whisk coupling unit in water.

- Unplug the appliance before cleaning.
- Disassemble all the parts.
- Do not immerse the motor unit into water.
- Wipe the motor unit with a moist doth..
- Clean the beaker, in the dishwasher or in warm water with some washing-up liquid.
- Dry and store them for future use.

AUTHORISED SERVICE CENTRE

For Gujarat, Maharashtra & West Bengal : 9167681234

Other Cities

Ajmer	0145-2421785/2423650	Hyderabad	040-35841992 / 9347020195
	9982347880	Indore	0731-2534689 / 4969975
Banglore	080 41249187 / 41138318	Jaipur	0141-2622483
Belgaum	9986224792	Jodhpur	0291-2435266 / 9414129574
Bhilwara	01482-224586 / 9414112586	Kota	0744 - 2390532 / 9460056594
Bhopal	0755 - 4282097	Raipur	0771-2533284 / 9425510814
Delhi	011-23847057 / 9811206109	Rudrapur	9837049123
Gulbarga	9741734070 / 9480162059	Sambalpur	0663-2400042 / 9338025787
Hubli	0836-2284897 / 9845277503	Udaipur	0294-2422075

To Register Your Complaint, Simply Send Hi on Whatsapp



9309133642

