

BOSS[®]

MIXER GRINDER INSTRUCTION MANUAL

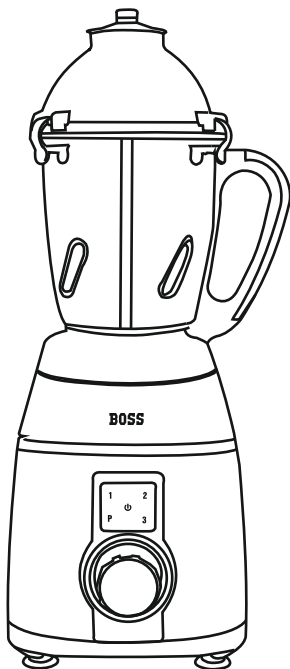

Please read all instructions carefully before using • *T & C Apply

Important

Please read the following important instruction carefully before using the product.

1. This appliance is not intended for use by persons (including children) with reduced physical, sensory or mental capabilities, or lack of experience and knowledge, unless they have been given supervision or instruction concerning use of the appliance by a person responsible for their safety.
2. Keep the machine away from direct heat and sunlight, at a suitable height on a flat surface for easy operation.
3. To protect against fire, electric shock & personal injury do not immerse the Motor Unit in water or any other liquid. Only use a moist cloth to clean the Mixer Body.
4. Do not run the Mixer Grinder empty. Do not overload the machine.
5. Do not operate without lid and lid cap fixed on the Jar. Never remove lid cap and add solid ingredients, when the motor is running.
6. Do not use the Mixer Grinder for ice crushing or grinding raw meat.
7. Fill the Grinder Jar only upto 1/4 of its capacity and add required amount of water or milk so that the blades don't get jammed.
8. Always unplug the appliance from the mains before you assemble, disassemble, clean or make adjustments to any of the accessories. Do not leave Mixer Grinder unattended while it is operating.
9. Do not Operate or touch the unit when smoke/burnt smell is observed. Contact the authorized Boss Customer Care Centre.
10. Do not use accessories not recommended by the manufacturer as there is a danger of fire, electric shock or personal injury.
11. This appliance is intended for household use only.

Precautions

1. Do not operate any appliance with a damaged cord or plug or after the appliance malfunctions or has been damaged in any manner. Return appliance to the nearest authorized service facility or call our customer service number for information on examination, repair, or adjustment.
2. Do not place on or near a hot gas or electric burner or in a heated oven.

Warning

1. Before running the machine ensure that the jars and lids are firmly placed and locked. Do not remove or replace jars when the motor is on.
2. Avoid contact with moving parts. Keep hands, hair, clothing, as well as spatulas and other utensils away from blades during the operation to reduce the risk of injury to persons and/or damage to the Mixer Grinder.

How To Use Your BOSS Mixer Grinder

- When operating the Mixer Grinder for the first time or after a long storage or non-usage: Rotate the Motor Shaft by hand until it rotates freely & smoothly. (Pict. 1) Ensure the unit is not connected to electrical power supply source.
- Before fixing the Jar to the main body, rotate the Jar coupler to ensure that it turns without any inconvenience. (Pict.2)
- Each Jar comes fitted with Aluminium/Plastic base, which has to be fitted in the main body unit. (Pict.3)
- Add the ingredients to be ground in the jar, put the Lid on top of Jar & Lock it.
- Plug the power cord in the electric supply socket & switch the power ON once everything is fitted properly in place.

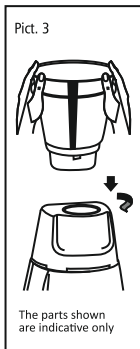
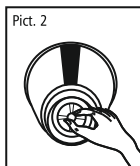
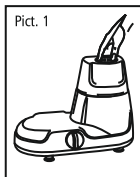

NOTE – Parts illustrated are indicative only.
Parts provided with the product may differ.

Using The Liquidiser / Wet Dry Grinding / Chutney Jar

1. Liquidiser Jar / Blender Jar is useful for blending Lassi, milkshakes, purees, juicer etc.
2. Dry/Wet Grinding Jar is useful for making batter for idli, dosa, grinding groundnut, dry red chilli, palak, other dry spices etc)
3. Chutney Jar is useful to grind small quantities of Chutney, Jeera, Coconut, Green Chilli, Pepper, Masala etc.
4. Cut/break ingredients into smaller pieces for best results.
5. Fix the jar on to the Motor unit, by aligning the marking of jar and main unit and rotate clockwise to lock the jar into position.
6. Fill the ingredients, close the jar lid and hold with hand. Operate the machine with the knob at the desired speed. (The Pulse switch can be used for additional froth in Lassi or Cold Coffee using the Liquidiser Jar / Blender Jar).
7. For wet grinding, Fill the jar with ingredients, and add some water as per desired quantity. Grind at a low speed for about 15 sec. Later move to a higher speed. Keep adding water till you achieve desired consistency. Fill the liquidiser jar only up to half of its capacity to avoid spillage.

Fruit Filter

The fruit filter is used for juicing soft seeded fruits like water melon, grapes etc. It can also be used to make tomato purees. Liquidiser jar without fruit filter is used for blending / liquidising applications.

Using The Fruit Filter

Insert the fruit filter into the Liquidiser jar and rotate it slightly so that it settles down and the grooves get locked with the slugs on the Liquidiser jar wall.

Care & Maintenance of BOSS Mixer Grinder

Cleaning After Use

Warning : Be sure to switch off your Mixer Grinder after use. Wait until the blades come to a halt before removing the cover.

1. After each use it is highly desirable to wash and thoroughly clean the jars blades and the lids.
2. Firstly remove the power plug from the electric supply socket, Gently detach the jar from the main unit.
3. Open the lid and empty the contents.
4. To remove the blade assembly, use a spoon to stop the blade from rotating and use Spatula to gently loosen/unscrew the plastic dome nut of blade assembly in clockwise direction (Fig.5)
5. Cleaning is easy & best done immediately after use.

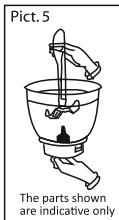

Cleaning After Use

1. Do not immerse the main unit in water. Clean the Body with a damp cloth and wipe dry.
2. Do not use abrasives or water for cleaning the motor unit.

To Clean The Jar

1. After every use of Mixer Grinder, Pour little hot water into the Jars to remove left over material, specially sticky substances, so that the Blade will rotate freely during the subsequent use.
2. Pour a little liquid soap and water into the jar, close the lid and run it on position 1 for a few seconds. Pour out the soap solution and rinse with tap water. Do not keep the jars immersed in water.
3. Alternatively use a soft brush to clean the filter under running tap water.
4. Rinse and Dry thoroughly
5. Always Store Jars in inverted position to allow water to drain off.

Over Load Protection (OLP)

To protect the motor from burning, in case of overload, the appliances is fitted with an automatic over load protector under the base of the motor unit. If the motor stops it is an indication of excess load. Switch off the unit, take out excess material from the jars. Turn the switch to 'O' Position. Wait for 2/3 minutes and press the overload protection plunger. Then restart the unit.

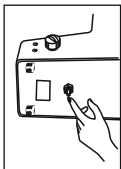

Note: Overload protection plunger is to be pressed to restart only after 2/3 minutes.

Trouble Shooting Guide

In case the following measures do not work, please connect to the nearest BOSS authorized Service Centre.

PROBLEM	CAUSE	CORRECTIVE MEASURES
Mixer does not start	No Electric Supply	Ensure electric supply
	Tripped due to overload	Switch off the electric supply and follow guidance mentioned in "OLP" section
Performance Dis satisfaction	Overloading	Fill the jar with ingredients into smaller appropriate size
	Large size of Ingredients	
	Wrong Jar/Blade use	Ensure the Jar and blade is right and used for intended purpose
Mixer generates abnormal noise	Jar is not locked properly	Ensure proper locking of the jar
	Loose Blade assembly	Tighten dome nut of blade assembly
	Loose Coupler	Tighten Coupler

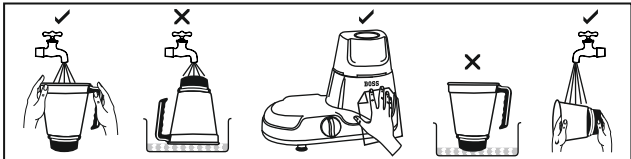

BOSS Mixer Grinders are available in various colors, power ratings and with varied combinations of attachments & accessories.

The specifications and design are subject to change without notice*